

RT. Gilmore

No. 3338.

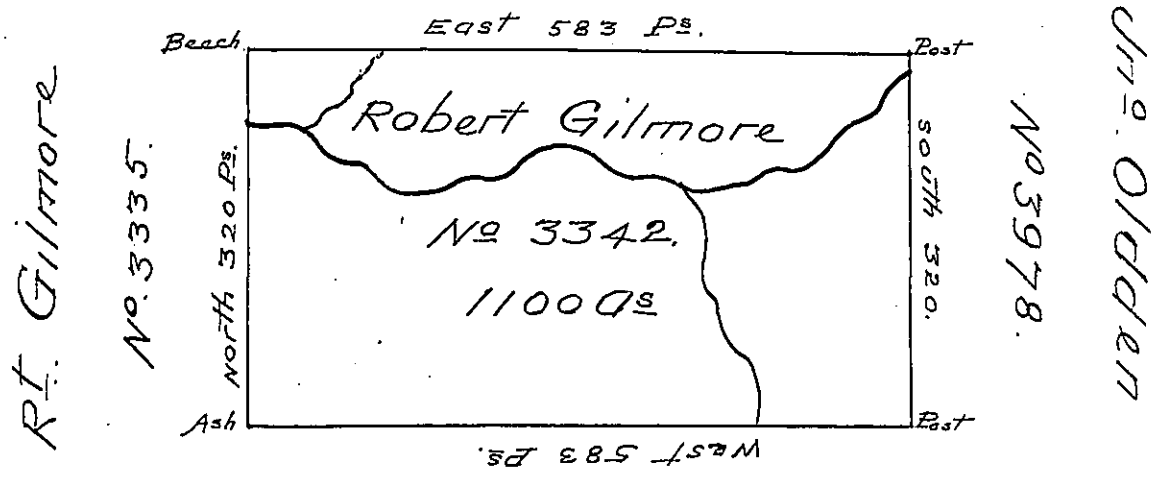

RT. Gilmore

No. 3335.

Sho. Olden
No 3978.

No 3347

Robt Gilmore

SITUATE on the Head of the East Branch of
 Ischunwangwandt Creek five miles South of the
 State Line in the last Purchase District No 4
 Surveyed June the twenty ninth 1793 in Pur-
 suance of a warrant to Robert Gilmore No.
 3342 Dated the fourteenth day of December
 1792 for 1000 Acres.

Containing Eleven hundred acres and the
 usual allowance of Six P^ct. for Roads.

P. James Hunter D.S.

To Daniel Brodhead Esq^r S.G.

June 29th

IN TESTIMONY that the above is a copy of the original remaining on file in
 the Department of Internal Affairs of Pennsylvania, made
 conformably to an Act of Assembly approved the 16th day of
 February, 1833, I have hereunto set my Hand and caused
 the Seal of said Department to be affixed at Harrisburg,
 this Twenty sixth day of October 1904.

Isaac P. Brown
 Secretary of Internal Affairs.